

AGMA 10  
1/8 FACE  
20° PRESSURE ANGLE

PHONE: 516.328.3300 • FAX: 516.326.8827 • WWW.SDP-SI.COM

**> MATERIAL:**

303 Stainless Steel  
2024-T4 Aluminum, Chromic anodized before cutting.

Available on special order:  
14-1/2° P.A., teeth not listed,  
different material, passivation  
for Stainless Steel.

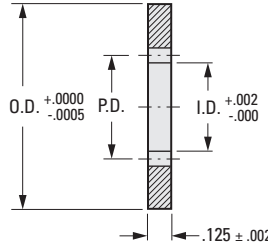
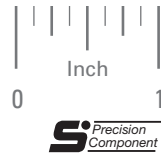
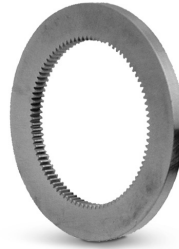

**INCH COMPONENT**

Catalog Number		No. of Teeth	P.D.	I.D.	O.D.
Stainless Steel	Aluminum				
<b>96 Pitch</b>					
S1E62Z-096S080	S1E62Z-096A080	80	.8333	.813	1.998
S1E62Z-096S100	S1E62Z-096A100	100	1.0417	1.021	1.998
S1E62Z-096S120	S1E62Z-096A120	120	1.2500	1.229	1.998
S1E62Z-096S140	S1E62Z-096A140	140	1.4583	1.438	1.998
S1E62Z-096S150	S1E62Z-096A150	150	1.5625	1.542	1.998
S1E63Z-096S150	S1E63Z-096A150	150	1.5625	1.542	2.998
S1E63Z-096S160	S1E63Z-096A160	160	1.6667	1.646	2.998
S1E63Z-096S180	S1E63Z-096A180	180	1.8750	1.854	2.998
S1E63Z-096S200	S1E63Z-096A200	200	2.0833	2.063	2.998
S1E63Z-096S240	S1E63Z-096A240	240	2.5000	2.479	2.998
S1E64Z-096S240	S1E64Z-096A240	240	2.5000	2.479	3.998
S1E64Z-096S250	S1E64Z-096A250	250	2.6042	2.583	3.998
S1E64Z-096S260	S1E64Z-096A260	260	2.7083	2.688	3.998
S1E64Z-096S280	S1E64Z-096A280	280	2.9167	2.896	3.998
S1E64Z-096S288	S1E64Z-096A288	288	3.0000	2.979	3.998
S1E64Z-096S300	S1E64Z-096A300	300	3.1250	3.104	3.998
<b>72 Pitch</b>					
S1E62Z-072S060	S1E62Z-072A060	60	.8333	.805	1.998
S1E62Z-072S080	S1E62Z-072A080	80	1.1111	1.083	1.998
S1E62Z-072S100	S1E62Z-072A100	100	1.3889	1.361	1.998
S1E62Z-072S110	S1E62Z-072A110	110	1.5278	1.500	1.998
S1E63Z-072S110	S1E63Z-072A110	110	1.5278	1.500	2.998
S1E63Z-072S120	S1E63Z-072A120	120	1.6667	1.639	2.998
S1E63Z-072S140	S1E63Z-072A140	140	1.9444	1.916	2.998
S1E63Z-072S160	S1E63Z-072A160	160	2.2222	2.194	2.998
S1E63Z-072S180	S1E63Z-072A180	180	2.5000	2.472	2.998
S1E64Z-072S180	S1E64Z-072A180	180	2.5000	2.472	3.998
S1E64Z-072S190	S1E64Z-072A190	190	2.6389	2.611	3.998
S1E64Z-072S200	S1E64Z-072A200	200	2.7778	2.750	3.998
S1E64Z-072S216	S1E64Z-072A216	216	3.0000	2.972	3.998
S1E64Z-072S220	S1E64Z-072A220	220	3.0556	3.027	3.998

AGMA 10  
1/8 FACE  
20° PRESSURE ANGLE

PHONE: 516.328.3300 • FAX: 516.326.8827 • WWW.SDP-SI.COM

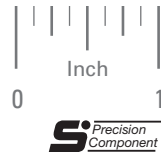
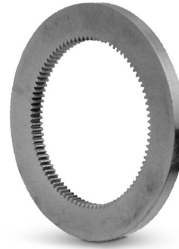

**► MATERIAL:**  
303 Stainless Steel  
2024-T4 Aluminum, Chromic anodized before cutting.

Available on special order:  
14-1/2° P.A., teeth not listed,  
different material, passivation  
for Stainless Steel.

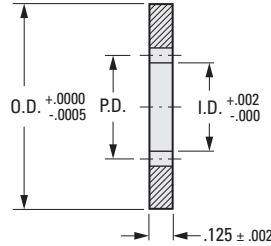

INCH COMPONENT		No. of Teeth	P.D.	I.D.	O.D.
Catalog Number					
Stainless Steel	Aluminum				
<b>64 Pitch</b>					
S1E62Z-064S050	S1E62Z-064A050	50	.7813	.750	1.998
S1E62Z-064S060	S1E62Z-064A060	60	.9375	.906	1.998
S1E62Z-064S070	S1E62Z-064A070	70	1.0938	1.062	1.998
S1E62Z-064S080	S1E62Z-064A080	80	1.2500	1.219	1.998
S1E62Z-064S090	S1E62Z-064A090	90	1.4063	1.375	1.998
S1E63Z-064S090	S1E63Z-064A090	90	1.4063	1.375	2.998
S1E63Z-064S100	S1E63Z-064A100	100	1.5625	1.531	2.998
S1E63Z-064S120	S1E63Z-064A120	120	1.8750	1.843	2.998
S1E63Z-064S140	S1E63Z-064A140	140	2.1875	2.156	2.998
S1E63Z-064S160	S1E63Z-064A160	160	2.5000	2.468	2.998
S1E64Z-064S160	S1E64Z-064A160	160	2.5000	2.468	3.998
S1E64Z-064S170	S1E64Z-064A170	170	2.6563	2.625	3.998
S1E64Z-064S180	S1E64Z-064A180	180	2.8125	2.781	3.998
S1E64Z-064S192	S1E64Z-064A192	192	3.0000	2.968	3.998
S1E64Z-064S200	S1E64Z-064A200	200	3.1250	3.093	3.998
<b>48 Pitch</b>					
S1E62Z-048S040	S1E62Z-048A040	40	.8333	.791	1.998
S1E62Z-048S050	S1E62Z-048A050	50	1.0417	1.000	1.998
S1E62Z-048S060	S1E62Z-048A060	60	1.2500	1.208	1.998
S1E62Z-048S070	S1E62Z-048A070	70	1.4583	1.416	1.998
S1E63Z-048S070	S1E63Z-048A070	70	1.4583	1.416	2.998
S1E63Z-048S080	S1E63Z-048A080	80	1.6667	1.625	2.998
S1E63Z-048S090	S1E63Z-048A090	90	1.8750	1.833	2.998
S1E63Z-048S100	S1E63Z-048A100	100	2.0833	2.041	2.998
S1E63Z-048S120	S1E63Z-048A120	120	2.5000	2.458	2.998
S1E64Z-048S120	S1E64Z-048A120	120	2.5000	2.458	3.998
S1E64Z-048S130	S1E64Z-048A130	130	2.7083	2.666	3.998
S1E64Z-048S140	S1E64Z-048A140	140	2.9167	2.875	3.998
S1E64Z-048S144	S1E64Z-048A144	144	3.0000	2.958	3.998
S1E64Z-048S156	S1E64Z-048A156	156	3.2500	3.208	3.998

# INTERNAL GEARS • 32 & 24 PITCH



AGMA 10  
1/8 FACE  
20° PRESSURE ANGLE

PHONE: 516.328.3300 • FAX: 516.326.8827 • WWW.SDP-SI.COM

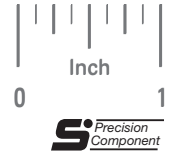
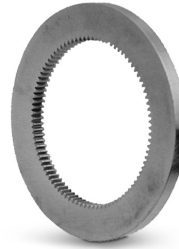

**MATERIAL:**  
303 Stainless Steel  
2024-T4 Aluminum, Chromic Anodized Before Cutting

Available on special order:  
14-1/2° P.A., teeth not listed,  
different material, passivation  
for Stainless Steel.

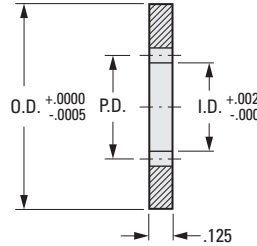

## INCH COMPONENT

Catalog Number		No. of Teeth	P.D.	I.D.	O.D.
Stainless Steel	Aluminum				
<b>32 Pitch</b>					
S1E62Z-032S025	S1E62Z-032A025	25	.7813	.718	1.998
S1E62Z-032S030	S1E62Z-032A030	30	.9375	.875	1.998
S1E62Z-032S035	S1E62Z-032A035	35	1.0938	1.031	1.998
S1E62Z-032S040	S1E62Z-032A040	40	1.2500	1.187	1.998
S1E62Z-032S045	S1E62Z-032A045	45	1.4063	1.343	1.998
S1E63Z-032S045	S1E63Z-032A045	45	1.4063	1.343	2.998
S1E63Z-032S050	S1E63Z-032A050	50	1.5625	1.500	2.998
S1E63Z-032S060	S1E63Z-032A060	60	1.8750	1.812	2.998
S1E63Z-032S070	S1E63Z-032A070	70	2.1875	2.125	2.998
S1E63Z-032S080	S1E63Z-032A080	80	2.5000	2.437	2.998
S1E64Z-032S080	S1E64Z-032A080	80	2.5000	2.437	3.998
S1E64Z-032S085	S1E64Z-032A085	85	2.6563	2.593	3.998
S1E64Z-032S090	S1E64Z-032A090	90	2.8125	2.750	3.998
S1E64Z-032S096	S1E64Z-032A096	96	3.0000	2.937	3.998
S1E64Z-032S100	S1E64Z-032A100	100	3.1250	3.062	3.998
<b>24 Pitch</b>					3.998
S1E62Z-024S020	S1E62Z-024A020	20	.8333	.750	1.998
S1E62Z-024S025	S1E62Z-024A025	25	1.0417	.958	1.998
S1E62Z-024S030	S1E62Z-024A030	30	1.2500	1.166	1.998
S1E62Z-024S035	S1E62Z-024A035	35	1.4583	1.375	1.998
S1E63Z-024S035	S1E63Z-024A035	35	1.4583	1.375	2.998
S1E63Z-024S040	S1E63Z-024A040	40	1.6667	1.583	2.998
S1E63Z-024S045	S1E63Z-024A045	45	1.8750	1.791	2.998
S1E63Z-024S050	S1E63Z-024A050	50	2.0833	2.000	2.998
S1E63Z-024S060	S1E63Z-024A060	60	2.5000	2.416	2.998
S1E64Z-024S060	S1E64Z-024A060	60	2.5000	2.416	3.998
S1E64Z-024S065	S1E64Z-024A065	65	2.7083	2.625	3.998
S1E64Z-024S070	S1E64Z-024A070	70	2.9167	2.834	3.998
S1E64Z-024S072	S1E64Z-024A072	72	3.0000	2.916	3.998
S1E64Z-024S078	S1E64Z-024A078	78	3.2500	3.166	3.998

14-1/2° PRESSURE ANGLE

PHONE: 516.328.3300 • FAX: 516.326.8827 • WWW.SDP-SI.COM

> MATERIAL:  
Brass

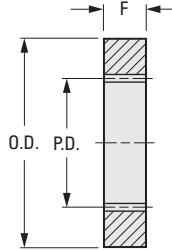
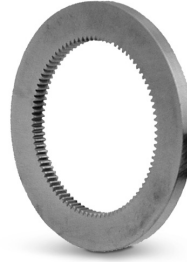

**INCH COMPONENT**

Catalog Number	No. of Teeth	P.D.	O.D.	F Face Width
<b>48 Pitch</b>				
A 1B10-N48048	48	1.000	1-1/2	1/8
A 1B10-N48072	72	1.500	2	1/8
A 1B10-N48084	84	1.750	2-1/2	1/8
A 1B10-N48096	96	2.000	2-3/4	1/8
A 1B10-N48120	120	2.500	3-1/4	1/8
<b>32 Pitch</b>				
A 1B10-N32032	32	1.000	1-1/2	3/16
A 1B10-N32064	64	2.000	2-3/4	3/16
A 1B10-N32080	80	2.500	3-1/4	3/16
<b>24 Pitch</b>				
A 1B10-N24048	48	2.000	2-3/4	1/4
A 1B10-N24060	60	2.500	3-1/4	1/4
A 1B10-N24072	72	3.000	3-3/4	1/4
A 1B10-N24144	144	6.000	6-3/4	1/4

- I
- R
- T
- 1**
- 2
- 3
- 4
- 5
- 6
- 7
- 8
- 9
- 10
- 11
- 12
- 13
- 14
- 15
- 16