

Bevel Gears

Straight 1:1 ratio

Steel, Brass & Polyacetal
4 DP to 64 DP

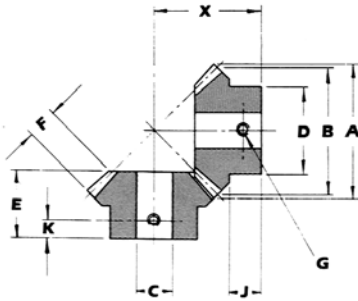

D.P.	No. Teeth	Outside Dia.	Pitch Dia.	Bore Dia.	Boss Dia.	Overall Length	Face Width	Setscrew	Boss Projection	Setscrew pos'n	Mounting Distance	Catalogue Reference		
		A	B	C	D	E	F	G	J	K	X	Steel	Brass	Delrin
4	24	6.096	6.000	1.500	4.000	3.563	1.33	-	1.94	-	5.500	B4-24-S	-	-
5	24	5.083	4.800	1.250	3.845	2.481	1.125	-	1.123	-	4.000	B5-24-S	-	-
5	25	5.283	5.000	1.375	3.500	3.000	1.100	-	1.750	-	4.625	B5-25-S	-	-
6	24	4.236	4.000	1.000	3.125	2.025	1.000	-	0.812	-	3.250	B6-24-S	-	-
8	24	3.177	3.000	0.750	2.343	1.374	0.625	-	0.577	-	2.375	B8-24-S	-	-
10	20	2.141	2.000	0.625	1.562	1.145	0.500	-	0.531	-	1.750	B10-20-S	-	-
10	25	2.641	2.500	0.750	1.875	1.315	0.562	-	0.561	-	2.124	B10-25-S	-	-
12	24	2.118	2.000	0.500	1.602	1.306	0.375	M6	0.801	0.375	2.000	B12-24-S	-	-
16	16	1.088	1.000	0.312	0.780	0.756	0.234	M4	0.455	0.187	1.064	B16-16-S	B-16-16-B	B-16-16-D
16	32	2.088	2.000	0.500	1.701	0.846	0.450	M4	0.351	0.156	1.500	B16-32-S	B-16-32-B	B-16-32-D
24	24	1.059	1.000	0.250	0.781	0.600	0.250	M4	0.307	0.156	0.906	B24-24-S	B-24-24-B	B-24-24-D
24	30	1.309	1.250	0.250	0.937	0.636	0.300	M4	0.307	0.156	1.031	B24-30-S	B-24-30-B	B-24-30-D
24	36	1.559	1.500	0.312	1.301	0.677	0.312	M4	0.338	0.156	1.187	B24-36-S	B-24-36-B	B-24-36-D
32	16	0.554	0.500	0.1875	0.390	0.351	0.125	M3	0.195	0.094	0.500	B32-16-S	B-32-16-B	B-32-16-D
32	24	0.794	0.750	0.1875	0.625	0.455	0.187	M3	0.250	0.125	0.687	B32-24-S	B-32-24-B	B-32-24-D
32	32	1.044	1.000	0.250	0.780	0.565	0.250	M3	0.265	0.156	0.875	B32-32-S	B-32-32-B	B-32-32-D
48	15	0.342	0.312	0.125	0.270	0.214	0.070	M3	0.135	0.070	0.312	B48-15-S	B-48-15-B	-
48	18	0.404	0.375	0.125	0.312	0.293	0.093	M3	0.188	0.094	0.406	B48-18-S	B-48-18-B	-
48	30	0.654	0.625	0.250	0.468	0.473	0.125	M3	0.295	0.156	0.687	B48-30-S	B-48-30-B	-
64	32	0.522	0.500	0.1875	0.390	0.407	0.125	M3	0.265	0.125	0.562	B64-32-S	B-64-32-B	-

Pitch line angle of each gear 45°

Material

Polyacetal
Steel BS970 Pt.1 1991 080M15 (EN32)
or BS970 Pt.3 1991 230M07 (EN1A)
Brass BS2874:1986 CZ121

All dimensions in inches

Pressure angle 20°

These bevel gears are cut to the Gleason System.

Bore tolerance to BS.1916:1953, Pt 1, H8

General tolerance unless otherwise stated $\pm 0.010''$.

Angular accuracy between shafts $\pm 0^{\circ}.5'$.

Shaft axes should intersect within $\pm 0.001''$.

Mounting distance tolerance (Dimn. X) \pm NIL, $-0.002''$.

These gears are NOT hardened.

Can only be run at a 90° shaft angle

Extra pinion or gear available

Bevel Gears

Straight 1.5:1 ratio

Steel, Brass & Polyacetal
6 DP to 64

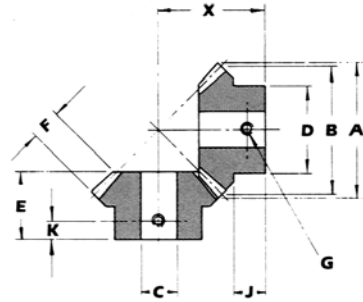

Bevel Gears

Straight 2:1 ratio

Steel, Brass & Polyacetal
6 DP to 64 DP

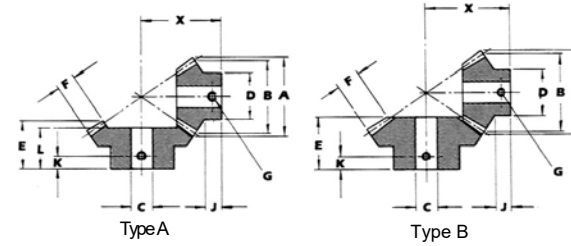

GEARS

GEARS

D.P.	No. Teeth	Outside Dia. A	Pitch Dia. B	Bore Dia. C	Boss Dia. D	Overall Length E	Face Width F	Setscrew G	Projection J	Setscrew pos'n K	Mounting Distance X	Catalogue Reference (sets)			
												Steel	Brass	Delrin	parts
6	16	3.015	2.667	0.938	2.343	1.698	0.75	-	0.892	-	3.000	B6-1.5-S	-	-	-PINION
	24	4.138	4.000	1.125	3.329	2.021	0.75	-	1.038	-	2.875	-	-	-	-GEAR
8	16	2.261	2.000	0.625	1.750	1.273	0.562	-	0.667	-	2.250	B8-1.5-S	-	-	-PINION
	24	3.103	3.000	0.625	2.497	1.359	0.562	-	0.622	-	2.000	-	-	-	-GEAR
10	16	1.809	1.600	0.500	1.405	1.209	0.437	-	0.735	-	2.000	B10-1.5-S	-	-	-PINION
	24	2.483	2.400	0.500	1.997	0.981	0.437	-	0.398	-	1.500	-	-	-	-GEAR
16	20	1.381	1.250	0.375	1.093	0.852	0.312	M5	0.510	0.250	1.500	B16-1.5-S	B16-1.5-B	B16-1.5-D	-PINION
	30	1.927	1.875	0.375	1.623	0.823	0.312	M5	0.436	0.218	1.250	-	-	-	-GEAR
20	16	0.904	0.800	0.250	0.703	0.729	0.218	M4	0.493	0.218	1.125	B20-1.5-S	B20-1.5-B	B20-1.5-D	-PINION
	24	1.241	0.200	0.250	1.000	0.615	0.218	M4	0.324	0.156	0.875	-	-	-	-GEAR
32	12	0.440	0.375	0.1250	0.312	0.325	0.112	M3	0.198	0.094	0.500	B32-1.5-S	B32-1.5-B	B32-1.5-D	-PINION
	18	0.588	0.562	0.156	0.437	0.386	0.112	M3	0.218	0.125	0.500	-	-	-	-GEAR
48	18	0.419	0.375	0.125	0.312	0.321	0.112	M3	0.198	0.094	0.500	B48-1.5-S	B48-1.5-B	-	-PINION
	27	0.580	0.562	0.125	0.478	0.319	0.112	M3	0.187	0.094	0.437	-	-	-	-GEAR
64	18	0.314	0.281	0.125	0.250	0.300	0.080	M3	0.216	0.094	0.500	B64-1.5-S	B64-1.5-B	-	-PINION
	27	0.435	0.422	0.125	0.359	0.284	0.080	M3	0.187	0.094	0.437	-	-	-	-GEAR

Pitch line angle of pinion (smaller) 33° 41'
Pitch line angle of gear (Larger) 56° 19'

D.P.	No. Teeth	Type	Outside Dia. A	Pitch Dia. B	Bore Dia. C	Boss Dia. D	Overall Length E	Face Width F	Boss Projection G	Projection J	K	Length through bore L	Mounting Distance X	Catalogue Reference		
														Steel	Brass	Polyacetal
6	15	A	2.901	2.500	0.750	2.240	1.774	1.082	-	0.685	-	-	3.25	B6-2-S	-	-
	30	A	5.098	5.000	1.000	3.125	2.533	1.082	-	1.445	-	2.344	3.250	-	-	-
6	18	A	3.041	3.000	1.125	2.500	-	1.060	-	1.590	-	2.766	4.750	B6-2X-S	-	-
	36	A	6.123	6.000	1.125	3.250	-	1.060	-	1.500	-	2.250	3.500	-	-	-
8	16	A	2.301	2.000	0.750	1.812	1.360	0.625	-	0.700	-	2.750	2.000	B8-2-S	-	-
	32	A	4.073	4.000	0.750	2.500	1.326	0.625	-	0.584	-	1.156	2.000	-	-	-
8	20	A	2.95	2.500	1.000	2.130	-	0.820	-	1.410	-	2.281	4.000	B8-2X-S	-	-
	40	A	5.120	5.000	1.000	3.000	-	0.820	-	1.250	-	-	2.875	-	-	-
10	16	A	1.841	1.600	0.500	1.440	1.191	0.562	-	0.609	-	1.844	2.250	B10-2-S	-	-
	32	A	3.259	3.200	0.500	1.875	1.111	0.562	-	0.492	-	0.982	1.625	-	-	-
10	20	A	2.063	2.000	0.750	1.750	-	0.710	-	1.060	-	1.797	3.125	B10-2X-S	-	-
	40	A	4.078	4.000	0.875	3.000	-	0.710	-	1.190	-	1.688	2.500	-	-	-
12	18	A	1.701	1.500	0.4375	1.365	1.168	0.500	M6	0.653	0.312	-	2.187	B12-2-S	-	-
	36	A	3.049	3.000	0.750	1.875	1.290	0.500	M6	0.598	0.312	1.018	1.625	-	-	-
16	20	A	1.400	1.250	0.375	1.150	1.051	0.450	M6	0.600	0.250	-	1.875	B16-2-S	-	B-16-2-D
	40	A	2.537	2.500	0.625	1.625	0.973	0.450	M6	0.542	0.250	0.893	1.375	-	-	-
16	18	A	1.019	1.000	0.375	0.810	-	0.350	-	0.440	-	-	1.500	B16-2X-S	-	-
	32	A	2.037	2.000	0.500	1.130	-	0.350	-	0.500	-	-	1.188	-	-	-
20	15	B	0.870	0.750	0.250	0.625	0.743	0.250	M3	0.690	0.218	-	1.250	B20-2-S	B-20-2-B	B-20-2-D
	30	B	1.529	1.500	0.500	1.000	0.755	0.250	M4	0.459	0.218	-	1.000	-	-	-
20	12	B	1.12	1.000	0.312	0.915	0.755	0.260	M5	0.479	0.187	-	1.500	B20-2X-S	B-20-2X-B	B-20-2X-D
	40	B	2.029	2.000	0.625	1.250	0.637	0.260	M5	0.334	0.156	-	1.000	-	-	-
32	12	B	0.450	0.375	0.1875	0.312	0.374	0.125	M3	0.235	0.125	-	0.625	B32-2X-S	B-32-2X-B	B-32-2X-D
	24	B	0.768	0.750	0.250	0.563	0.380	0.125	M3	0.209	0.125	-	0.500	-	-	-
32	16	B	0.575	0.500	0.1875	0.445	0.429	0.187	M3	0.207	0.125	-	0.750	B32-2-S	B-32-2-B	B-32-2-D
	32	B	1.018	1.000	0.1875	0.625	0.441	0.187	M3	0.243	0.125	-	0.597	-	-	-
32	18	B	0.638	0.562	0.188	0.468	0.315	0.125	M3	0.164	0.075	-	0.751	B32-2Y-S	B-32-2Y-B	B-32-2Y-D
	36	B	1.143	1.125	0.188	0.625	0.322	0.125	M3	0.149	0.075	-	0.534	-	-	-
48	18	B	0.425	0.375	0.125	0.312	0.37	0.125	M3	0.235	0.125	-	0.625	B48-2-S	B-48-2-B	-
	36	B	0.762	0.750	0.125	0.390	0.313	0.125	M3	0.180	0.094	-	0.437	-	-	-
64	18	B	0.319	0.281	0.125	0.25	0.294	0.104	M3	0.187	0.094	-	0.476	B64-2-S	B-64-2-B	-
	36	B	0.572	0.562	0.188	0.511	0.348	0.104	M3	0.244	0.125	-	0.437	-	-	-

Pitch line angle of pinion (smaller) 26° 34'
Pitch line angle of gear (larger) 63° 26'

Material

Polyacetal
Steel BS970 Pt.1 1991 080M15 (EN32)
or BS970 Pt.3 1991 230M07 (EN1A)
Brass BS2874:1986 CZ121

All dimensions in inches

Pressure angle 20°

These bevel gears are cut to the Gleason System.

Bore tolerance to BS.1916:1953, Pt 1, H8

General tolerance unless otherwise stated ±0.010".

Angular accuracy between shafts ±0°-5'.

Shaft axes should intersect within ±0.001".

Mounting distance tolerance (Dimm. X)+NIL, -.002".

These gears are NOT hardened.

Can only be run at a 90° shaft angle

Extra pinion or gear available

Material

Polyacetal
Steel BS970 Pt.1 1991 080M15 (EN32)
or BS970 Pt.3 1991 230M07 (EN1A)
Brass BS2874:1986 CZ121

All dimensions in inches

Pressure angle 20°

These bevel gears are cut to the Gleason System.

Bore tolerance to BS.1916:1953, Pt 1, H8

General tolerance unless otherwise stated ±0.010".

Angular accuracy between shafts ±0°-5'.

Shaft axes should intersect within ±0.001".

Mounting distance tolerance (Dimm. X)+NIL, -.002".

These gears are NOT hardened.

Can only be run at a 90° shaft angle

Extra pinion or gear available

Bevel Gears

Straight 3:1 ratio

Steel, Brass & Polyacetal
6 DP to 64 DP

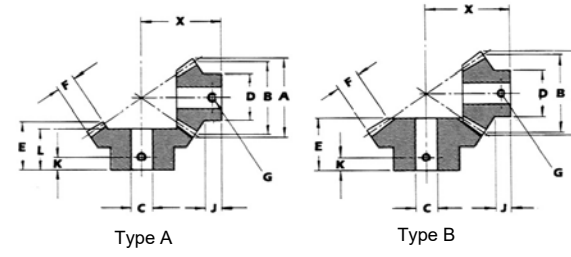
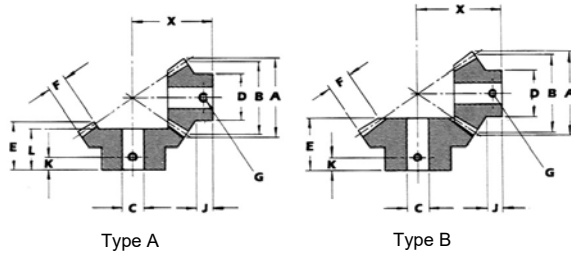

Bevel Gears

Straight 4:1 ratio

Steel, & Brass 6 DP to 64 DP

GEARS

GEARS

D.P.	No. Teeth	Type	Outside Dia. A	Pitch Dia. B	Bore Dia. C	Boss Dia. D	Overall Length E	Face Width F	Boss Setscrew G	Boss Projection J	Setscrew pos'n K	Length through bore L	Mounting Distance X	Catalogue Reference				
														Steel set	Brass set	Delrin set	Parts	
6	12	A	2.446	2.000	0.750	1.750	2.053	1.062		0.959			4.000	B6-3-S				-PIN
	36	A	6.602	6.000	1.000	3.125	1.888	1.062		0.902			2.500	B6-3-S				-GEAR
8	12	A	1.834	1.500	0.500	1.250	1.776	0.781		0.959			3.250	B8-3-S				-PIN
	36	A	4.547	4.500	1.000	3.125	2.037	0.781		1.301		1.87	2.500	B10-3-S				-GEAR
10	12	A	1.467	1.200	0.375	1.015	1.258	0.625		0.606			2.437	B10-3-S				-PIN
	36	A	3.637	3.600	0.625	2.375	1.630	0.625		1.041		1.496	2.000	B10-3-S				-GEAR
10	20		2.345	2.000	0.875	1.750	2.156	0.780		1.310		2.156	4.375	B10-3X-S				-PIN
	60		6.020	6.000	1.000	3.000	1.859	0.780		1.375		1.859	2.750	B10-3X-S				-GEAR
12	12	A	1.223	1.000	0.375	0.875	1.027	0.531	M5	0.485	0.250		2.000	B12-3-S				-PIN
	36	A	3.031	3.000	0.625	2.000	1.319	0.531	M6	0.826	0.375	1.209	1.625	B12-3-S				-GEAR
16	12	A	0.917	0.750	0.250	0.625	1.089	0.406	M3	0.666	0.312		1.820	B16-3-S				-PIN
	36	A	2.273	2.250	0.500	1.687	1.148	0.406	M6	0.776	0.375	1.066	1.375	B16-3-S				-GEAR
32	12	B	0.459	0.375	0.125	0.312	0.436	0.187	M3	0.239	0.125		0.812	B32-3-S	B-32-3-B	B-32-3-D		-PIN
	36	B	1.137	1.125	0.250	0.545	0.382	0.187	M3	0.200	0.094		0.500	B32-3-S	B-32-3-B	B-32-3-D		-GEAR
48	18	B	0.431	0.375	0.125	0.340	0.417	0.170	M3	0.244	0.125		0.812	B48-3-S	B-48-3-B			-PIN
	54	B	1.133	1.125	0.188	0.545	0.311	0.170	M3	0.175	0.094		0.437	B48-3-S	B-48-3-B			-GEAR
64	18	B	0.323	0.281	0.125	0.250	0.340	0.140	M3	0.198	0.094		0.625	B64-3-S	B-64-3-B			-PIN
	54	B	0.850	0.844	0.188	0.390	0.346	0.140	M3	0.240	0.125		0.437	B64-3-S	B-64-3-B			-GEAR

D.P.	No. Teeth	Type	Outside Dia.		Pitch Dia.	Bore Dia.	Boss Dia.	Overall Length	Face Width	Setscrew	Boss Projection	Setscrew pos'n	Length through bore	Mounting Distance	Catalogue Reference		
			A	B											Steel set	Brass set	Part
6	12	A	2.463	2.000	0.750	1.750	1.821	1.062			0.719			4.750	B6-4-S		-PIN
6	36	A	8.046	8.000	1.562	3.905	2.318	1.062			1.384		2.063	3.000	B6-4-S		-GEAR
10	12	A	1.478	1.200	0.438	1.050	0.981	0.625			0.332			2.750	B10-4-S		-PIN
10	36	A	4.828	1.800	0.938	2.343	1.463	0.625			0.906		1.309	1.875	B10-4-S		-GEAR
16	12	A	0.924	0.750	0.250	0.656	0.659	0.406	M3	0.238	0.125			1.750	B16-4-S		-PIN
16	36	A	3.017	3.000	0.562	1.405	0.871	0.406	M6	0.519	0.250	0.776	1.125	B16-4-S		-GEAR	
32	12	B	0.462	0.375	0.156	0.320	0.500	0.250	M3	0.243	0.125			1.000	B32-4-S	B-32-4-B	-PIN
32	36	B	1.508	1.500	0.250	0.702	0.445	0.250	M3	0.259	0.125			0.562	B32-4-S	B-32-4-B	-GEAR
48	18	B	0.433	0.375	0.125	0.341	0.466	0.218	M3	0.245	0.125			1.000	B48-4-S	B-48-4-B	-PIN
48	54	B	1.505	1.500	0.188	0.702	0.310	0.218	M3	0.173	0.094			0.437	B48-4-S	B-48-4-B	-GEAR
64	18	B	0.325	0.281	0.125	0.250	0.343	0.156	M3	0.183	0.094			0.750	B64-4-S	B-64-4-B	-PIN
64	54	B	1.129	1.125	0.188	0.545	0.403	0.156	M3	0.302	0.125			0.500	B64-4-S	B-64-4-B	-GEAR

Pitch line angle of pinion (smaller) 18° 26'
Pitch line angle of gear (larger) 71° 34'

Pitch line angle of pinion (smaller) 14° 02'
Pitch line angle of gear (larger) 75° 58'

Material
Polyacetal
Steel BS970 Pt.1 1991 080M15 (EN32)
or BS970 Pt.3 1991 230M07 (EN1A)
Brass BS2874:1986 CZ121

All dimensions in inches
Pressure angle 20°
These bevel gears are cut to the Gleason System.
Bore tolerance to BS.1916:1953, Pt 1, H8
General tolerance unless otherwise stated ±0.010".
Angular accuracy between shafts ±0°-5'.
Shaft axes should intersect within ±0.001".
Mounting distance tolerance (Dimn. X)+NIL, -.002".

These gears are NOT hardened.
Can only be run at a 90° shaft angle
Extra pinion or gear available

Material
Polyacetal
Steel BS970 Pt.1 1991 080M15 (EN32)
or BS970 Pt.3 1991 230M07 (EN1A)
Brass BS2874:1986 CZ121

All dimensions in inches
Pressure angle 20°
These bevel gears are cut to the Gleason System.
Bore tolerance to BS.1916:1953, Pt 1, H8
General tolerance unless otherwise stated ±0.010".
Angular accuracy between shafts ±0°-5'.
Shaft axes should intersect within ±0.001".
Mounting distance tolerance (Dimn. X)+NIL, -.002".

These gears are NOT hardened.
Can only be run at a 90° shaft angle
Extra pinion or gear available

Bevel Gears

Straight 1:1 ratio

Steel, 0.5 to 6.0 module

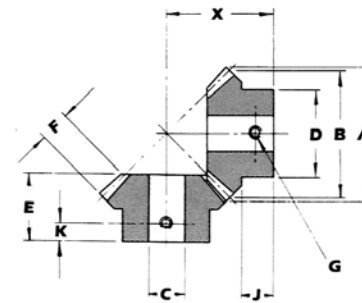
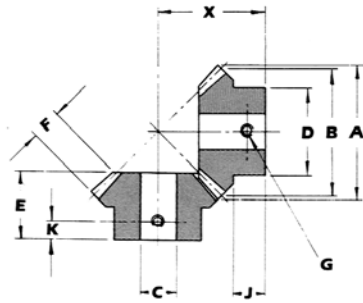

Bevel Gears

Straight 1:1 ratio

Stainless Steel moulded polyacetal

GEARS

Mod	No. Teeth	Outside Dia.	Pitch Dia.	Bore Dia.	Boss Dia.	Overall Length	Face Width	Setscrew	Boss Projection	Setscrew pos'n	Mounting Distance	Catalogue Reference
		A	B	C	D	E	F	G	J	K	X	
0.5	15	8.21	7.5	3.00	6.6	5.54	1.5	M2.5	3.80	2.0	8.0	MB05-15-S-MITRE
0.5	18	9.71	9.0	4.00	7.5	7.14	2.0	M2.5	4.77	2.5	10.0	MB05-18-S-MITRE
0.5	20	10.7	10.0	3.00	8.0	8.00	2.5	-	5.00	-	11.0	MB05-20-B-MITRE
0.5	30	15.71	15.0	6.00	13.0	8.86	3.0	M3	5.51	2.5	14.0	MB05-30-S-MITRE
0.8	16	13.93	12.8	6.00	10.0	9.58	3.0	M3	5.70	3.0	13.5	MB08-16-S-MITRE
0.8	20	17.1	16.0	5.00	12.0	11.00	3.7	-	6.00	-	-	MB08-20-B-MITRE
0.8	24	20.33	19.2	6.00	16.0	11.10	4.0	M3	6.32	3.0	17.5	MB08-24-S-MITRE
0.8	32	26.73	25.6	8.00	22.0	12.45	5.5	M4	6.40	3.0	21.0	MB08-32-S-MITRE
1.0	16	17.41	16.0	6.00	12.5	10.92	3.5	M2.5	6.25	3.0	16.0	MB10-16-S-MITRE
1.0	19	20.41	19.0	6.00	15.0	11.79	4.0	M3	6.51	3.0	18.0	MB10-19-S-MITRE
1.0	20	21.4	20.0	6.00	16.0	12.00	5.0	-	8.00	-	20.0	MB10-20-S-MITRE
1.0	26	27.41	26.0	8.00	22.0	13.36	5.5	M4	7.00	3.5	22.0	MB10-26-S-MITRE
1.0	30	31.41	30.0	8.00	26.0	15.55	6.5	M5	8.49	4.0	25.5	MB10-30-S-MITRE
1.5	16	26.12	24.0	8.00	20.0	16.23	5.0	M4	10.00	5.0	24.0	MB15-16-S-MITRE
1.5	19	30.62	28.5	8.00	25.0	17.68	6.0	M5	11.00	5.5	27.0	MB15-19-S-MITRE
1.5	20	32.1	30.0	8.00	26.0	19.00	8.0	-	13.00	-	30.0	MB15-20-S-MITRE
1.5	26	41.12	39.1	10.00	32.0	22.50	9.0	M6	12.00	6.0	35.0	MB15-26-S-MITRE
1.5	30	47.12	45.0	12.00	38.0	23.75	10.0	M6	12.51	6.0	38.5	MB15-30-S-MITRE
2.0	16	34.83	32.0	10.00	25.0	18.85	7.0	-	9.52	-	29.0	MB20-16-S-MITRE
2.0	19	40.83	38.0	10.00	30.0	23.22	9.0	-	12.02	-	35.0	MB20-19-S-MITRE
2.0	20	42.8	40.0	12.00	34.0	22.00	10.0	-	14.00	-	37.0	MB20-20-S-MITRE
2.0	26	54.83	52.0	12.00	44.0	28.35	12.0	-	15.00	-	45.0	MB20-26-S-MITRE
2.0	30	62.83	60.0	12.00	50.0	28.75	14.0	-	13.23	-	48.0	MB20-30-S-MITRE
2.5	16	43.54	40.0	12.00	30.0	24.97	9.000	-	12.51	-	37.5	MB25-16-S-MITRE
2.5	19	51.04	47.5	12.00	40.0	28.12	11	-	15.52	-	43.0	MB25-19-S-MITRE
2.5	20	53.5	50.0	14.00	42.0	19.00	12	-	19.00	-	48.0	MB25-20-S-MITRE
2.5	26	68.53	65.0	14.00	54.0	33.20	15	-	16.00	-	54.0	MB25-26-S-MITRE
2.5	30	78.53	75.0	16.00	64.0	35.10	17	-	16.51	-	59.5	MB25-30-S-MITRE
3.0	16	52.24	48.0	15.00	40.0	29.08	11	-	16.00	-	44.0	MB30-16-S-MITRE
3.0	19	61.24	57.0	16.00	50.0	31.01	13	-	17.02	-	49.0	MB30-19-S-MITRE
3.0	20	64.2	60.0	16.00	50.0	35.00	15	-	23.00	-	58.0	MB30-20-S-MITRE
3.0	26	82.24	78.0	18.00	64.0	40.03	18	-	19.03	-	65.0	MB30-26-S-MITRE
3.0	30	94.24	90.0	20.00	76.0	39.65	21	-	16.51	-	68.5	MB30-30-S-MITRE
4.0	16	69.66	64.0	15.00	50.0	35.81	15	-	16.49	-	55.5	MB40-16-S-MITRE
4.0	19	81.66	76.0	18.00	62.5	41.43	18	-	20.24	-	65.0	MB40-19-S-MITRE
4.0	20	85.7	80.0	20.00	64.0	27.00	20	-	27.00	-	75.0	MB40-20-S-MITRE
4.0	26	109.66	104.0	22.00	85.0	48.69	24	-	20.50	-	82.0	MB40-26-S-MITRE
4.0	30	125.66	120.0	25.00	102.0	51.51	28	-	21.00	-	90.0	MB40-30-S-MITRE
5.0	16	87.07	80.0	20.00	62.5	42.93	18	-	19.27	-	68.0	MB50-16-S-MITRE
5.0	19	102.07	95.0	25.00	72.0	49.23	22	-	20.00	-	79.0	MB50-19-S-MITRE
5.0	20	107.1	100.0	25.00	80.0	54.00	26	-	30.00	-	90.0	MB50-20-S-MITRE
5.0	26	137.07	130.0	30.00	106.1	61.37	30	-	26.06	-	103.0	MB50-26-S-MITRE
5.0	30	157.07	150.0	30.00	127.0	58.90	35	-	20.50	-	107.0	MB50-30-S-MITRE
6.0	16	104.5	96.0	30.00	70.0	60.15	22	-	28.98	-	90.0	MB60-16-S-MITRE
6.0	19	122.48	114.0	35.00	87.5	68.99	26	-	34.76	-	105.0	MB60-19-S-MITRE
6.0	20	128.5	120.0	28.00	100.0	60.00	30	-	34.00	-	104.0	MB60-20-S-MITRE
6.0	26	164.49	156.0	50.00	128.0	95.05	36	-	52.80	-	145.0	MB60-26-S-MITRE
6.0	30	188.49	180.0	55.00	144.0	73.2	42	-	52.00	-	132.0	MB60-30-S-MITRE

Material

0.5 to 0.8mod steel
BS970 Pt1 1991 08M15 (EN32) or
BS970 P13 1991 230M07 (EN1A)
1.0 to 6.0 mode steel
BS970 P13 1991 08M40 (EN8) or Equivalent

All dimensions in millimetres
Pressure angle 20°
These bevel gears are cut to the Gleason System. Bore tolerance to BS 4500: 1969,H8
General tolerance unless otherwise stated ±0.25 Angular accuracy between shafts ±0°-5'.
Shaft axes should intersect within ±0.025
Mounting distance tolerance (Dimm. X)+NIL, -.005.

These gears are NOT hardened. Can only be run at a 90° shaft angle Extra pinion or gear available

mod	No. Teeth	Outside Dia. A	Pitch Dia. B	Bore Dia. +0.001-0.002 Ø C	Boss Dia. Ø D	Length thru bore E	Boss Proj'n J	Mounting Distance X	Catalogue molded
0.5	16	8.70	8	3.00	-	8.0	6.0	10.5	MB 05 - 16 - MOLD-MTR
	20	10.70	10	3.00	7.0	8.0	4.0	11.0	MB 05 - 20 - MOLD-MTR
1	16	17.60	16	5.00	8.0	13.6	8.0	18.4	MB 10 - 16 - MOLD-MTR
	20	21.40	20	6.00	12.0	14.6	7.0	21.0	MB 10 - 20 - MOLD-MTR
1.5	16	26.40	24	8.00	16.0	18.4	10.0	25.8	MB 15 - 16 - MOLD-MTR
	20	21.40	20	6.00	18.5	14.6	7.0	21.0	MB 15 - 20 - MOLD-MTR
2	16	34.90	32	8.00	16.0	21.2	9.6	30.4	MB 20 - 16 - MOLD-MTR
2.5	16	43.50	40	8.00	21.9	25.5	11.5	37.0	MB 25 - 16 - MOLD-MTR
3	16	52.30	48	14.00	25.2	29.2	13.2	43.0	MB 30 - 16 - MOLD-MTR
3.5	16	61.40	56	18.00	28.8	33.1	14.4	49.5	MB 35 - 16 - MOLD-MTR

mod	No. Teeth	Outside Dia. A	Pitch Dia. B	Bore Dia. H7 Ø C	Boss Dia. Ø D	Length thru bore	Boss Proj'n J	Mounting Distance X	Catalogue Reference
0.6	20	12.8	12	4*	7	5.5	3	10	* MB 06 - 20 - SS -MITRE
1	20	21.4	20	6	16	12	8	20	MB 10 - 20 - SS - MITRE
1	25	26.4	25	6	20	14	8	23	MB 10 - 25 - SS - MITRE
1.5	20	32.1	30	8	26	19	13	30	MB 15 - 20 - SS - MITRE
1.5	25	39.6	37.5	10	30	19	11.5	34	MB 15 - 25 - SS - MITRE
2	20	42.8	40	12	34	22	14	37	MB 20 - 20 - SS - MITRE
2	25	52.8	50	12	45	20	12.5	40	MB 20 - 25 - SS - MITRE
2.5	20	53.5	50	14	42	29	19	48	MB 25 - 20 - SS - MITRE
2.5	25	66.0	62.5	16	55	26	15	50	MB 25 - 25 - SS - MITRE
3	20	64.2	60	16	50	35	23	58	MB 30 - 20 - SS - MITRE
3	25	79.2	75	20	65	32	17.5	60	MB 30 - 25 - SS - MIT

* +0.018
Pitch angle 45°
* 431 stainless steel

Material

Moulded polyacetal
Stainless Steel 303

All dimensions in millimetres
Pressure angle 20°
These bevel gears are cut to the Gleason System. Bore tolerance to BS 4500: 1969,H7
General tolerance unless otherwise stated ±0.25 Angular accuracy between shafts ±0°-5'.
Shaft axes should intersect within ±0.025
Mounting distance tolerance (Dimm. X)+NIL, -.005.

These gears are NOT hardened. Can only be run at a 90° shaft angle Extra pinion or gear available

GEARS

Bevel Gears

Straight 1.5:1 ratio

Steel 1.0 to 6.0 module

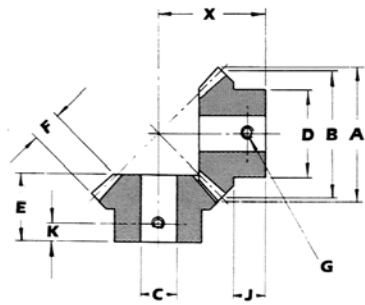

Bevel Gears

Straight 2:1 ratio

Steel 1.0 to 6.0 module

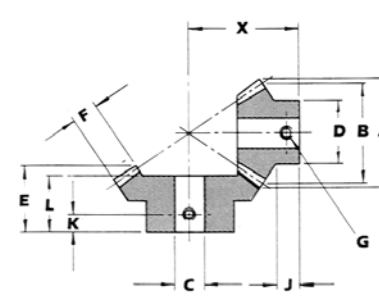

GEARS

GEARS

mod	No. Teeth	Outside Dia. A Ø	Pitch Dia. B Ø	Bore Dia. H8 C Ø	Boss Dia. D Ø	Overall Length E	Face Width F	Boss Projection J	Length through bore L	Mounting Distance X	Catalogue Reference (set) Steel	Parts
1.0	15	16.79	15	5	12.5	12.80	5	8.00	12.0	23	MB10-2X-S	-PIN
	30	30.89	30	8	22.0	15.40		9.00	14.0	20		-GEAR
1.5	15	25.19	22.5	8	19.0	19.10	8	10.60	18.0	34	MB15-2X-S	-PIN
	30	46.34	45	10	32.0	21.20		13.00	19.0	28		-GEAR
1.5	16	27.61	24	10	21.0 *	19.74	8	11.24	19.9	36	MB15-2-S	-PIN
	32	48.88	48	10	40.0 *	22.12		13.00		30		-GEAR
2.0	15	33.58	30	10	25.0	23.80	11.5	12.00	22.0	43	MB20-2X-S	-PIN
	30	61.80	60	14	40.0	26.30		15.00	23.0	35		-GEAR
2.0	16	36.81	32	12	28.5	23.99	10	13.35	25.5	45.5	MB20-2-S	-PIN
	32	65.17	64	14	40.0	28.24		16.36		39		-GEAR
2.5	15	41.98	37.5	12	31.0	29.20	14.5	14.00	27.0	53	MB25-2X-S	-PIN
	30	77.25	75	18	50.0	30.90		17.00	27.0	42		-GEAR
2.5	16	46.01	40	12	36.0	27.76	12	15.00	32.8	56	MB25-2-S	-PIN
	32	81.47	80	16	50.0	36.32		21.69		50		-GEAR
3.0	15	50.37	45	14	38.0	34.00	17	16.00	32.0	63	MB30-2X-S	-PIN
	30	92.70	90	20	60.0	35.80		19.00	31.0	49		-GEAR
3.0	16	55.22	48	15	43.0	28.65	15	12.74	36.8	62	MB30-2-S	-PIN
	32	97.76	96	20	62.5	40.84		23.01		57		-GEAR
3.5	15	58.77	53	16	44.0	38.90	19.5	18.50	36.0	63	MB35-2X-S	-PIN
	30	108.15	105	22	70.0	41.50		22.00	36.0	49		-GEAR
3.5	16	64.42	56	16	50.0	33.50	18	14.49	38.6	72	MB35-2-S	-PIN
	32	114.05	112	22	62.5	43.33		22.35		62		-GEAR
4.0	15	67.16	60	18	50.0	43.80	22	20.50	41.0	83	MB40-2X-S	-PIN
	30	123.60	120	25	80.0	47.10		25.00	42.0	65		-GEAR
4.0	16	73.62	64	20	57.5	36.53	20	15.37	43.0	81	MB40-2-S	-PIN
	32	130.34	128	25	70.0	48.44		24.69		70		-GEAR
4.5	15	75.56	67.5	20	55.0	49.20	25	22.50	46.0	93	MB45-2X-S	-PIN
	30	139.02	135	30	90.0	53.00		28.00	47.0	73		-GEAR
4.5	16	82.83	72	22	62.5	40.54	22	16.62	51.4	91	MB45-2-S	-PIN
	32	146.64	144	28	87.5	57.56		31.00		82		-GEAR
5.0	15	83.95	75	22	60.0	54.50	28	24.00	51.0	103	MB50-2X-S	-PIN
	30	154.46	150	35	100.0	57.90		30.00	51.0	80		-GEAR
5.0	16	92.03	80	22	70.0	50.39	25	23.50	56.2	106	MB50-2-S	-PIN
	32	162.93	160	30	100.0	63.04		33.35		90		-GEAR
6.0	15	100.74	90	25	75.0	60.80	32.5	26.20	56.0	120	MB60-2X-S	-PIN
	30	185.34	180	40	120.0	63.20		33.00	54.0	90		-GEAR
6.0	16	110.44	96	35	86.5	67.61	35	31.62	62.1	130	MB60-2-S	-PIN
	32	195.52	192	45	112.5	89.71		52.02		120		-GEAR

* boss has 1 x M4 tapped hole into bore

Pitch line angle 26° 34'
Gear pitch angle 63° 26'

Mod	No. of Teeth	Outside Dia. A Ø	Pitch Dia. B Ø	Bore Dia. C Ø	Boss Dia. D Ø	Face Width F	Boss projection J	Length through bore L	Mounting Distance X	Catalogue Ref (set) STEEL	(parts)
1.0	16	17.66	16	5	13.5	4.5	7.2	11.0	20	MB10-1.5XS	- PIN
	24	25.11	24	6	21		9.3	13.5	20		- GEAR
1.5	16	26.49	24	8	20	7	10.6	17.0	30	MB15-1.5X-S	-PIN
	24	37.67	36	8	26		12.0	17.0	27		-GEAR
2.0	16	35.32	32	10	26	10	12.0	21.0	38	MB20-1.5X-S	-PIN
	24	50.22	48	12	35		15.0	23.0	35		-GEAR
2.5	16	44.16	40	12	32	12.5	13.5	25.0	46	MB25-1.5X-S	-PIN
	24	62.77	60	14	42		16.0	27.0	42		-GEAR
3.0	16	53.00	48	14	40	14.5	15.5	28.0	54	MB30-1.5X-S	-PIN
	24	75.32	72	16	50		18.0	30.0	49		-GEAR
3.5	16	61.82	56	16	47	17	17.0	32.0	62	MB35-1.5X-S	-PIN
	24	87.88	84	18	58		21.0	36.0	57		-GEAR
4.0	16	70.65	64	18	54	19	18.5	35.0	70	MB40-1.5X-S	-PIN
	24	100.43	96	20	66		24.0	40.0	65		-GEAR
4.5	16	79.48	72	20	60	21.5	21.0	40.0	79	MB45-1.5X-S	-PIN
	24	113.00	108	25	75		26.0	45.0	73		-GEAR
5.0	16	88.32	80	22	65	24	23.0	45.0	88	MB50-1.5X-S	-PIN
	24	125.54	120	30	85		28.0	49.0	80		-GEAR
6.0	16	106.96	96	25	80	28.5	24.7	50.0	102	MB60-1.5X-S	-PIN
	24	150.66	144	35	105		32.0	52.5	90		-GEAR

Pitch line angle 33° 41'
Gear pitch angle 56° 19'

Material

Steel

All dimensions in millimetres
Pressure angle 20°
These bevel gears are cut to the Gleason System.
Bore tolerance to BS 4500: 1969,H7
General tolerance unless otherwise stated ±0.25
Angular accuracy between shafts ±0°-5'
Shaft axes should intersect within ±0.025
Mounting distance tolerance (Dimm. X)+NIL, -.005.

These gears are NOT hardened. Can only be run at a 90° shaft angle Extra pinion or gear available

Material

Steel BS970 Pt. 3 1991 080M40 (EN8) or equivalent
All dimensions in millimetres
Pressure angle 20°
These bevel gears are cut to the Gleason System. Bore tolerance to BS 4500: 1969,H7
General tolerance unless otherwise stated ±0.25 Angular accuracy between shafts ±0°-5'.
Shaft axes should intersect within ±0.025
Mounting distance tolerance (Dimm. X)+NIL, -.005.

Bevel Gears

Straight 2.5:1 ratio

Steel 1.0 to 6.0 module

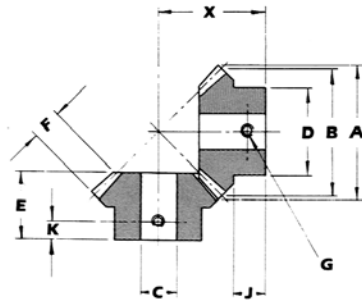

Bevel Gears

Straight 3:1 ratio

Steel 1.0 to 6.0 module

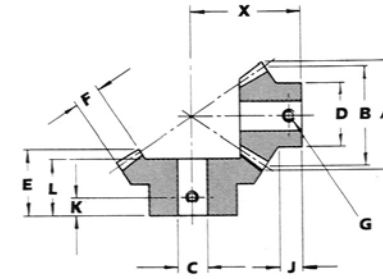

GEARS

GEARS

Mod	Teeth No.	Outside Dia. A Ø	Pitch Dia. B Ø	Bore Dia. C Ø	Boss Dia. D Ø	Face Width F	Boss Projection J	Length through bore L	Mounting Distance X	Catalogue Ref (set) STEEL	(parts)
1.0	16	17.86	16	5	13.5	6	7.5	13.0	28	MB 10 - 2.5X - S	-PIN
	40	40.74	40	8	25		9.0	14.0	21		-GEAR
1.5	16	26.79	24	8	20	9	11.2	19.5	42	MB 15 - 2.5X - S	-PIN
	40	61.11	60	12	38		13.5	20.0	30		-GEAR
2.0	16	35.71	32	12	26	13.5	14.0	26.0	55	MB 20 - 2.5X - S	-PIN
	40	81.48	80	18	50		18.0	26.0	39		-GEAR
2.5	16	44.64	40	14	32	17.0	15.5	32.0	67	MB 25 - 2.5X - S	-PIN
	40	101.85	100	20	60		20.0	30.0	46		-GEAR
3.0	16	53.56	48	16	40	20	17.5	36.0	79	MB 30 - 2.5X - S	-PIN
	40	122.22	120	22	70		23.0	36.0	55		-GEAR
3.5	16	62.49	56	18	45	23.5	19.0	41.0	91	MB 35 - 2.5X - S	-PIN
	40	142.59	140	25	80		26.0	40.0	62		-GEAR
4.0	16	71.42	64	20	52	27	21.5	47.0	104	MB 40 - 2.5X - S	-PIN
	40	162.97	160	30	90		30.0	46.0	72		-GEAR
4.5	16	80.35	72	22	60	30	23.5	52.0	116	MB 45 - 2.5X - S	-PIN
	40	183.34	180	35	100		34.0	52.0	81		-GEAR
5.0	16	89.28	80	25	65	33	26.0	58.0	129	MB 50 - 2.5X - S	-PIN
	40	203.71	200	40	110		36.0	56.0	88		-GEAR
6.0	16	107.16	96	25	80	36.5	26.8	62.0	150	MB 60 - 2.5X - S	-PIN
	40	244.44	240	40	125		34.0	55.0	95		-GEAR

Pinion pitch angle 21° 48'

Gear pitch angle 68° 12'

Mod	No. Teeth	Outside Dia. A Ø	Pitch Dia. B Ø	Bore Dia. H8 C Ø	Boss Dia. D Ø	Overall Length E	Face Width F	Boss Projection J	Length through bore L	Mounting Distance X	Catalogue Reference
1.0	15	16.90	15	5	12.5	15.40	7	8.0	14.5	31.0	MB10-3X-S -PIN
	45	45.63	45	10	28.0	17.40		10.0	15.5	22.0	-GEAR
1.5	15	25.35	22.5	8	19.0	22.10	10	11.6	21.0	46.0	MB15-3X-S -PIN
	45	68.45	67.5	14	40.0	23.90		14.5	21.5	31.0	-GEAR
1.5	16	28.01	24	10	21.0	22.30	12	10.0 *	46.5	33.0	MB15-3-S -PIN
	48	72.56	72	12	40.0	25.27		15.6 *	23.2	33.0	-GEAR
2.0	15	33.79	30	12	25.0	28.70	14	14.0	27.0	60.0	MB20-3X-S -PIN
	45	91.26	90	18	50.0	31.70		20.0	28.0	41.0	-GEAR
2.0	16	37.35	32	12	28.5	28.83	15	13.4	62.0	43.0	MB20-3-S -PIN
	48	96.75	96	16	53.0	32.44		19.8	29.6	43.0	-GEAR
2.5	15	42.24	37.5	14	31.0	33.80	17.5	15.5	32.0	73.0	MB25-3X-S -PIN
	45	114.08	112.5	20	60.0	36.40		22.0	32.0	48.0	-GEAR
2.5	16	46.68	40	12	36.0	32.84	18	14.3	75.0	53.0	MB25-3-S -PIN
	48	120.93	120	20	65.0	39.57		24.0	36.0	53.0	-GEAR
3.0	15	50.68	45	16	38.0	39.00	21	17.5	37.0	86.0	MB30-3X-S -PIN
	45	136.89	135	22	70.0	42.10		25.0	37.0	56.0	-GEAR
3.0	16	56.02	48	15	42.0	32.06	18	13.0	86.0	61.0	MB30-3-S -PIN
	48	145.12	144	22	70.0	43.85		26.2	39.2	61.0	-GEAR
3.5	15	59.13	52.5	18	44.0	45.20	24.5	20.0	43.0	100.0	MB35-3X-S -PIN
	45	159.71	157.5	25	80.0	47.80		28.0	42.0	64.0	-GEAR
3.5	16	65.36	56	16	50.0	38.00	22	15.0	100.0	68.0	MB35-3-S -PIN
	48	169.31	168	25	87.5	48.29		27.4	43.0	68.0	-GEAR
4.0	15	67.58	60	20	50.0	51.40	28	22.5	49.0	114.0	MB40-3X-S -PIN
	45	182.52	180	30	90.0	54.50		32.0	48.0	73.0	-GEAR
4.0	16	74.69	64	20	57.5	41.99	25	15.9	113.0	81.0	MB40-3-S -PIN
	48	193.49	192	28	100.0	58.42		15.9	52.3	81.0	-GEAR
4.5	15	76.03	67.5	22	55.0	57.10	31	24.5	54.0	128.0	MB45-3X-S -PIN
	45	205.34	202.5	35	105.0	60.10		35.0	53.0	81.0	-GEAR
4.5	16	84.03	72	22	65.5	53.49	28	24.3	133.5	91.0	MB45-3-S -PIN
	48	217.68	216	32	112.5	65.56		38.8	58.7	91.0	-GEAR
5.0	15	84.48	75	25	60.0	62.80	34	27.0	60.0	142.0	MB50-3X-S -PIN
	45	228.10	225	40	120.0	65.60		38.0	58.0	89.0	-GEAR
5.0	16	93.37	80	22	72.0	50.72	35	14.7	136.0	93.0	MB50-3-S -PIN
	48	241.87	240	32	125.0	65.86		35.0	58.6	93.0	-GEAR
6.0	15	101.40	90	25	75.0	70.20	41	27.5	66.0	165.0	MB60-3X-S -PIN
	45	273.78	270	45	140.0	70.00		35.0	60.0	98.0	-GEAR
6.0	16	112.04	96	40	86.5	75.11	50	24.4	170.0	98.0	MB60-3-S -PIN
	48	290.25	288	55	137.5	114.73		75.5	106.7	145.0	-GEAR

* boss has 1 x M6 tapped hole into bore

Pitch line angle of pinion (smaller) 18° 26'
Pitch line angle of gear (larger) 71° 34'

Material

Steel BS970 Pt. 3 1991 080M40 (EN8) or equivalent

All dimensions in millimetres

Pressure angle 20°

These bevel gears are cut to the Gleason System. Bore tolerance to BS 4500: 1969,H7

General tolerance unless otherwise stated ±0.25 Angular accuracy between shafts ±0°-5'

Shaft axes should intersect within ±0.025

Mounting distance tolerance (Dimn. X)+NIL, -.005.

These gears are NOT hardened. Can only be run at a 90° shaft angle Extra pinion or gear available

Material

Steel BS970 Pt. 3 1991 080M40 (EN8) or equivalent

All dimensions in millimetres

Pressure angle 20°

These bevel gears are cut to the Gleason System. Bore tolerance to BS 4500: 1969,H7

General tolerance unless otherwise stated ±0.25 Angular accuracy between shafts ±0°-5'

Shaft axes should intersect within ±0.025

Mounting distance tolerance (Dimn. X)+NIL, -.005.

These gears are NOT hardened. Can only be run at a 90° shaft angle Extra pinion or gear available

Bevel Gears

Straight - 4:1 ratio

Steel 1.5 to 6.0 module

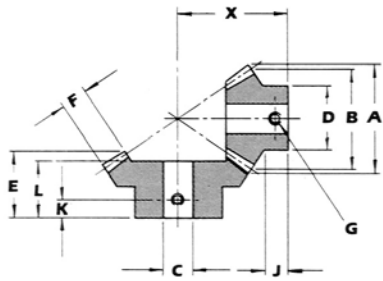

Bevel Gears

Straight moulded

Steel 1.5,2,3,4 & 5

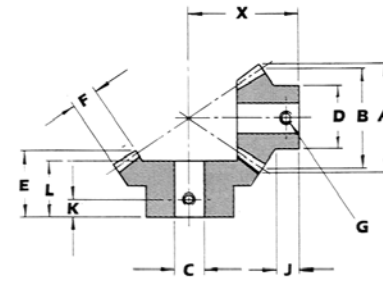

Mod	No. Teeth	Outside Dia. A Ø	Pitch Dia. B Ø	Bore Dia. H8 C Ø	Boss Dia. D Ø	Overall Length E	Face Width F	Boss Projection J	Length through bore L	Mounting Distance X	Catalogue Reference	
											Set	Parts
1.0	15	16.94	15	5	12.5	16.90	9	7.7	16.5	38.0		-PIN
	60	60.49	60	12	35.0	18.40	10.0	10.0	16.5	23.0	MB15-4X-S	-GEAR
1.5	15	25.41	22.5	8	19.0	23.90	12	11.5	23.0	57.0		-PIN
	60	90.74	90	16	50.0	25.70	15.5	15.5	23.0	33.0	MB15-4X-S	-GEAR
1.5	16	28.17	24	10	21.0	28.50	12	16.1 *		64.5		-PIN
	64	96.42	96	15	50.0	28.50	19.5 *	19.5 *	26.1	37.0	MB15-4-S	-GEAR
2.0	15	33.88	30	12	25.0	30.80	16	14.5	30.0	75.0		-PIN
	60	120.97	120	20	65.0	35.30	22.0	14.5	30.0	45.0	MB20-4X-S	-GEAR
2.0	16	37.55	32	12	28.5	31.45	18	13.1		77.5		-PIN
	64	128.55	128	16	62.5	33.07	20.6	20.6	30.1	44.0	MB20-4-S	-GEAR
2.5	15	42.35	37.5	14	31.0	37.80	20	17.0	36.0	93.0		-PIN
	60	151.21	150	22	80.0	40.90	25.0	25.0	36.0	53.0	MB25-4X-S	-GEAR
2.5	16	46.94	40	12	36.0	36.96	22	14.5		95.0		-PIN
	48	160.69	160	20	75.0	40.23	24.8	24.8	26.5	54.0	MB25-4-S	-GEAR
3.0	15	50.82	45	16	38.0	44.80	24	20.0	43.0	111.0		-PIN
	60	181.45	180	28	95.0	47.40	28.0	28.0	42.0	62.0	MB30-4X-S	-GEAR
3.0	16	56.33	48	15	43.0	43.99	25	18.4		115.0		-PIN
	48	192.83	192	25	87.5	48.16	29.9	29.9	43.5	65.0	MB30-4-S	-GEAR
3.5	15	59.29	52.5	18	44.0	51.70	28	23.0	50.0	129.0		-PIN
	60	211.69	210	32	110.0	52.00	30.0	30.0	46.0	69.0	MB35-4X-S	-GEAR
3.5	16	65.72	56	16	50.0	57.96	30	27.3		140.0		-PIN
	48	224.97	224	28	112.5	57.53	36.1	36.1	52.2	77.0	MB35-4-S	-GEAR
4.0	15	67.76	60	20	48.0	56.80	32	23.5	55.0	145.0		-PIN
	60	241.92	240	35	125.0	60.60	36.0	36.0	53.0	80.0	MB40-4X-S	-GEAR
4.0	16	75.11	64	20	58.0	59.13	30	28.2		157.0		-PIN
	48	257.10	256	32	125.0	65.81	42.2	42.2	59.4	89.0	MB40-4-S	-GEAR
5.0	15	84.70	75	25	60.0	69.70	40	28.1	67.0	180.0		-PIN
	60	302.40	300	45	160.0	70.80	40	38.0	62.0	95.0	MB50-4X-S	-GEAR
5.0	16	93.88	80	35	72.5	74.63	50	24.0		185.0		-PIN
	48	312.39	320	55	137.5	113.77	50	81.5	106.7	140.0	MB50-4-S	-GEAR
6.0	15	101.64	90	25	75.0	74.70	45	28.1	71.0	210.0		-PIN
	60	362.88	360	50	180.0	73.30	45	38.0	62.0	103.0	MB60-4X-S	-GEAR

* boss has 1 x M6 tapped hole into bore

Pitch line angle of pinion (smaller)
Pitch line angle of gear (larger)

14° 02'
75° 58'

Mod	Teeth No.	Outside Dia. A	Pitch Dia. B	Bore Dia. C <small>+0.001-0.002</small>	Boss Dia. D	Overall Length E	Boss Dia. J	Mounting Distance X	Catalogue Ref moulded (set)	(parts)	
1.5:1 ratio											
1.5	16	26.00	24.00	8.000	20.0	18.8	10.8	30.0	MB 15 - 1.5X - MOLD	-PIN -GR	
	24	37.00	36.00	10.000	24.0	19.6	11.3	26.6			
2 : 1 ratio											
0.5	20	11.20	10.00	3.000	8.0	8.5	4.0	16.0	MB 05 - 2X - MOLD	-PIN -GR	
	40	20.30	20.00	4.000	12.0	8.3	4.0	12.0			
0.8	20	17.90	16.00	4.000	12.0	11.5	5.0	24.0	MB 08 - 2X - MOLD	-PIN -GR	
	40	32.50	32.00	5.000	15.0	11.9	6.0	18.0			
1	20	22.40	20.00	5.000	15.0	14.5	7.0	30.0	MB 10 - 2X - MOLD	-PIN -GR	
	40	40.00	40.00	6.000	18.0	14.5	7.0	22.0			
1	15	16.80	15.00	5.000	12.2	17.0	10.6	26.4	MB 10 - 2Y - MOLD	-PIN -GR	
	30	31.10	30.00	8.000	18.0	16.2	9.1	20.9			
1.5	15	25.40	22.50	8.000	17.0	22.8	11.5	35.8	MB 15 - 2X - MOLD	-PIN -GR	
	30	46.40	45.00	10.000	23.4	19.5	9.6	26.2			
2	15	33.60	30.00	10.000	22.5	27.0	11.8	44.2	MB 20 - 2X - MOLD	-PIN -GR	
	30	62.20	60.00	10.000	30.2	24.2	11.8	32.6			
2.5	15	42.00	37.50	12.000	26.5	31.2	13.0	53.3	MB 25 - 2X - MOLD	-PIN -GR	
	30	77.30	75.00	14.000	36.1	29.5	15.0	40.5			
3	15	50.30	45.00	14.000	31.2	36.3	14.8	63.3	MB 30 - 2X - MOLD	-PIN -GR	
	30	93.00	90.00	18.000	45.0	37.0	19.0	49.5			
3 : 1 ratio											
1	15	16.60	15.00	4.000	12.3	20.4	11.0	34.3	MB 10 - 3X - MOLD	-PIN -GR	
	45	46.10	45.00	10.000	23.4	18.2	9.6	22.7			
1.5	15	25.10	22.50	8.000	17.2	26.8	12.5	47.9	MB 15 - 3X - MOLD	-PIN -GR	
	45	68.80	67.50	10.000	30.4	23.0	11.5	29.4			
2	10	24.00	20.00	6.000	15.5	25.0	12.0	43.7	MB 20 - 3X - MOLD	-PIN -GR	
	30	61.70	60.00	12.000	30.3	22.5	11.5	28.0			
2.5	10	29.70	25.00	8.000	18.8	28.8	13.0	52.4	MB 25 - 3X - MOLD	-PIN -GR	
	30	77.20	75.00	18.000	36.1	29.0	15.5	35.7			
4 : 1 ratio											
1	10	12.00	10.00	4.000	7.8	17.7	9.3	30.1	MB 10 - 4X - MOLD	-PIN -GR	
	40	40.80	40.00	10.000	23.4	17.0	10.8	20.1			
1.5	10	18.00	15.00	5.000	11.3	23.5	10.9	41.7	MB 15 - 4X - MOLD	-PIN -GR	
	40	61.20	60.00	12.000	30.4	21.7	12.8	26.2			
2	10	23.80	20.00	6.000	14.3	28.9	12.8	54.0	MB 20 - 4X - MOLD	-PIN -GR	
	40	81.50	80.00	10.000	36.0	27.0	16.6	32.5			
5 : 1 ratio											
1	12	13.70	12.00	4.000	9.5	20.3	10.0	21.0	MB 10 - 5X - MOLD	-PIN -GR	
	60	60.40	60.00	10.000	20.5	17.4	11.0	40.5			

These gears are NOT hardened. Can only be run at a 90° shaft angle Extra pinion or gear available

Material

Steel BS970 Pt. 3 1991 080M40 (EN8) or equivalent

All dimensions in millimetres

Pressure angle 20°

These bevel gears are cut to the Gleason System. Bore tolerance to BS 4500: 1969,H7

General tolerance unless otherwise stated ±0.25 Angular accuracy between shafts ±0°-5'

Shaft axes should intersect within ±0.025

Mounting distance tolerance (Dimn. X)+NIL, -.005.

These gears are NOT hardened. Can only be run at a 90° shaft angle Extra pinion or gear available

Material

Steel BS970 Pt. 3 1991 080M40 (EN8) or equivalent

All dimensions in millimetres

Pressure angle 20°

These bevel gears are cut to the Gleason System. Bore tolerance to BS 4500: 1969,H7

General tolerance unless otherwise stated ±0.25 Angular accuracy between shafts ±0°-5'

Shaft axes should intersect within ±0.025

Mounting distance tolerance (Dimn. X)+NIL, -.005.

GEARS